

CENTRAL POINT CEMETERY

ESTABLISHED 1868

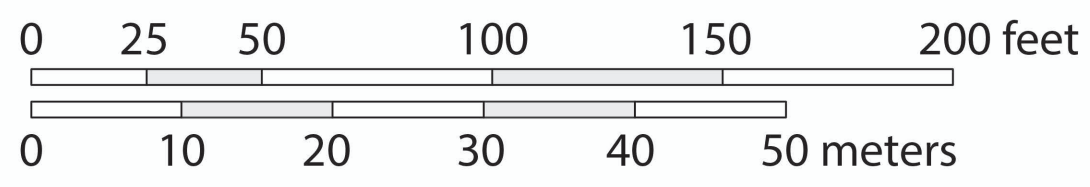

Cemetery land expanded/surveyed in 4 phases

Original (Pioneer) Cemetery survey certified April 23, 1892 (1-72)
 • in Donation Land Claim 56 in Township 37 South, Range 2 West

1st Addition survey certified August 29, 1908
 • originally 73-287 (59 surveyed blocks have no surface evidence or are covered by development)
 • blocks on map (73-251) exist or would fit on current land

2nd Addition survey certified January 23, 1922
 • starting in far southeast corner 1-1 moving north to 10-26

3rd Addition survey certified Dec 28, 1922
 • originally 1-1 to 1-15 directly north of 2nd addition
 • only 10 blocks remain
 • 101 blocks have been covered by development to the north



- 222 Existing Block with survey number
- 222 Block that could exist but no surface evidence

Contour interval = 2 ft

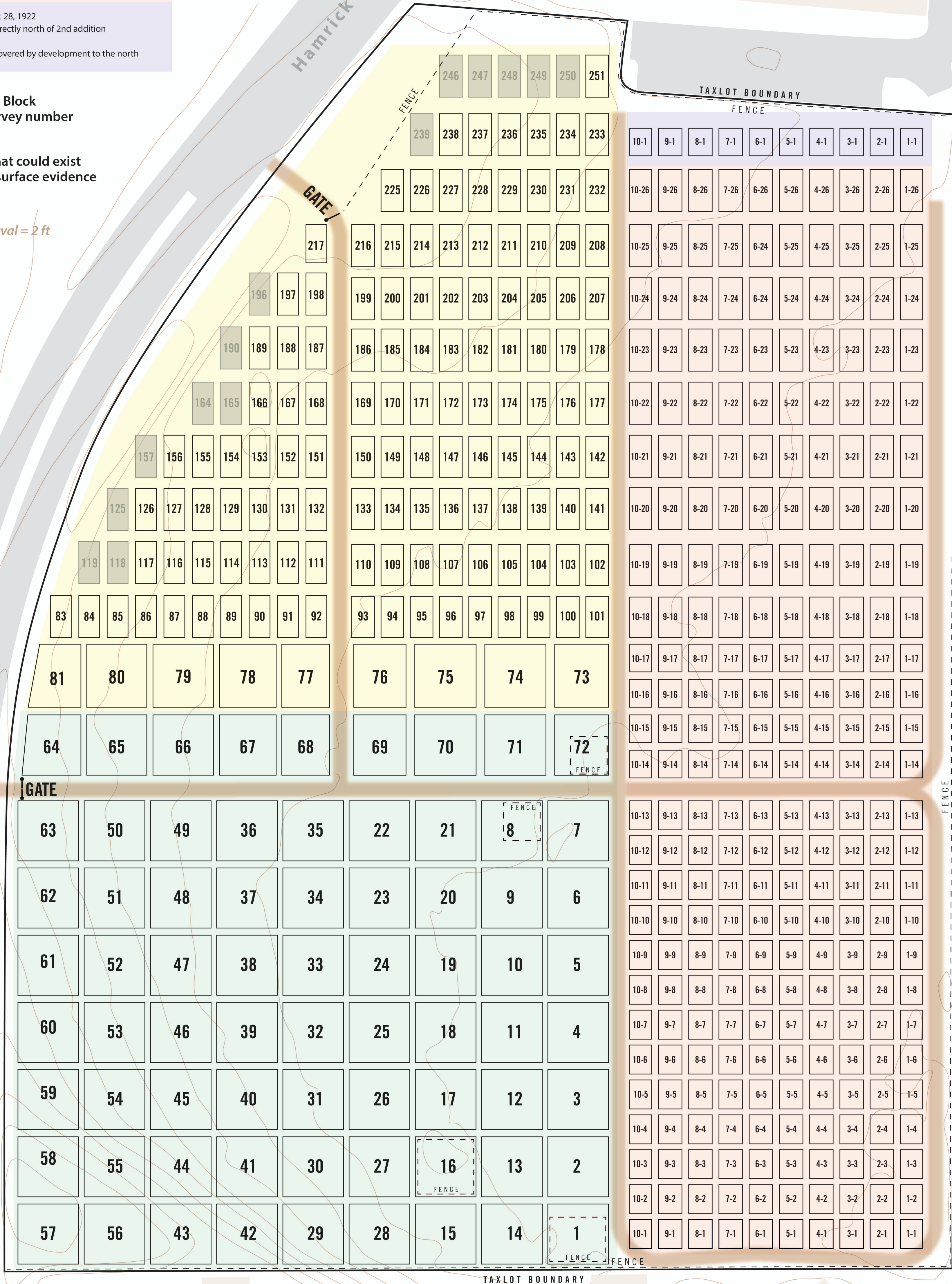

For more information, please contact:
 Dave Jacob, 541-423-1012 or dave.jacob@centralpointoregon.gov
 Office: 140 S. Third Street, Central Point, Oregon 97502
www.centralpointoregon.gov/parksrec/page/central-point-cemetery

